



ASA-RT s.r.l.

Strada del Lionetto 16/a, 10146 Torino, ITALY
 Tel +39 011 796333 - 720467 - FAX +39 011 712339
 E-Mail: info@asa-rt.com http:// www.asa-rt.com

**COMPRESSION LOAD CELL
 KOMPRESSIIONSMESSDOSE**

ATB - GR

Data sheet GR / 03 / 3 Datenblatt

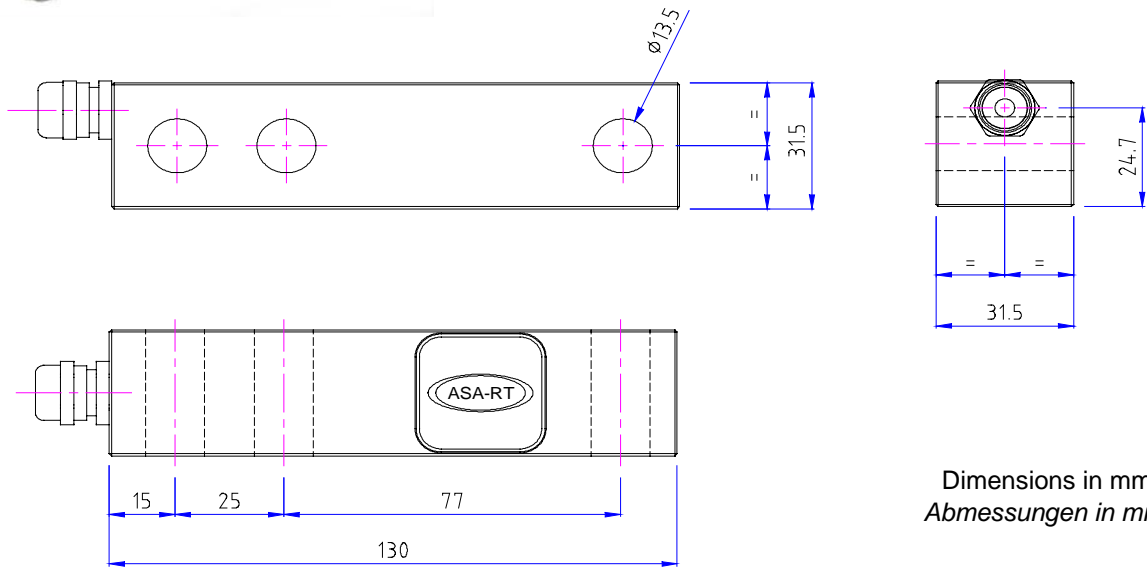

Dimensions in mm
 Abmessungen in mm

Type Typ	Nominal Force F Meßbereich F	Material Material
ATB - GR / 10	10 N	Avional / Avional
ATB - GR / 20	20 N	
ATB - GR / 50	50 N	
ATB - GR / 100	100 N	
ATB - GR / 200	200 N	
ATB - GR / 500	500 N	
ATB - GR / 1000	1000 N	Stainless steel / rostbeständiger Edelstahl
ATB - GR / 1500	1500 N	
ATB - GR / 2500	2500 N	
ATB - GR / 5000	5000 N	

Technical Data		Technische Daten
- Ultimate Load	> 200% F	- Bruchlast
- Accuracy	0.2% F	- Genauigkeit
- Sensitivity	2mV / V	- Empfindlichkeit
- Repeatability (total error hysteresis and non-linearity)	< 0.3% F	- Wiederholgenauigkeit (gesamt Hysteresis-Abweichung und Nicht-linearität)
- Zero bridge balance	±1% F	- Nullpunktabweichung
- Temperature effect on zero	± 0.1% F / 10° C	- Temperatureinfluß auf den Nullpunkt
- Nominal temperature range	(+10 ...+60° C) or (+10...+100° C)	- Nenntemperaturbereich
- Bridge resistance	350 ohm	- Brückenwiderstand
- Maximum supply voltage	12 Vdc	- Max. Speisespannung
- Protection Level	IP65	- Schutzgrad
- Material	Avional / Avional Stainless steel rostbeständiger Edelstahl	- Material
- Cable	3 m	- Kabel
- Resonance frequency	750 Hz	- Resonanzfrequenz
- Deformation	0.3 mm	- Verformung

ASSEMBLING EXAMPLE
EINBAUBEISPIELE

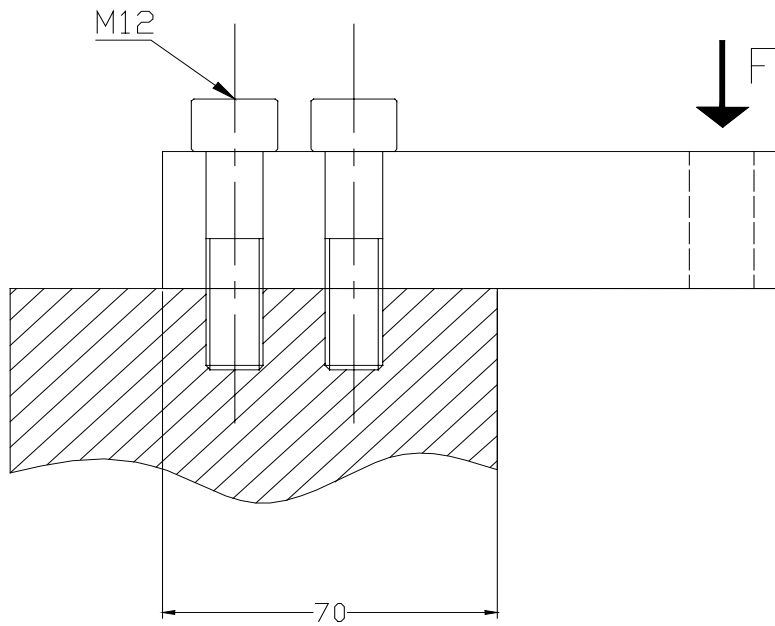

The load cell ATB-GR has not internal protection to overload, so it is necessary to grant that in each case (both during the normal use and during the transport), the maximal value indicated in this data sheet is not exceeded, otherwise the load cell could be damaged.

When the sensors are used in the tanks (or something else) weighing, where the load cells must be already assembled during the transport, it is necessary to use the A-GR1 accessory, which allows to protect the load cell itself and makes the assembling easier.

ELECTRICAL CONNECTION
ELEKTRISCHE ANSCHLÜSSE

Signal Names <i>Signal-bezeichnung</i>	Connection with 6 wires + shield <i>Anschluß mit 6 Adern + Abschirmung</i>	Teflon cable with 7 wires + shield <i>Teflonkabel mit 7 Adern + Abschirmung</i>
EXC -	brown / <i>braun</i>	yellow / <i>gelb</i>
SNS -	white / <i>weiß</i>	black / <i>schwarz</i>
SIG -	yellow / <i>gelb</i>	green / <i>grün</i>
EXC +	grey / <i>grau</i>	brown / <i>braun</i>
SNS +	pink / <i>rosa</i>	red / <i>rot</i>
SIG +	green / <i>grün</i>	white / <i>weiß</i>
SCH	shield / <i>Abschirmung</i>	shield / <i>Abschirmung</i>
N.C.		grey / <i>grau</i>

ORDER CODE
BESTELLCODE

